



CTP WIDENING PROJECT

August 2025



FM 1187 to US 67

NTTA is widening the mainlanes of the Chisholm Trail Parkway (CTP) approximately 13 miles from FM 1187 in Tarrant County to US 67 in Johnson County. This work will include construction of two new mainlanes, allowing for two continuous lanes in each direction, and is expected to be open to traffic in late 2028.

As construction begins this summer, please use caution and observe speed limits and safety signage.

We thank you for your patience as we work to widen the roadway.

What's Complete?

- In May 2025, the NTTA Board of Directors approved contracts for construction, construction management, and materials testing.

What's Next?

- Construction signage, environmental protection and temporary barriers will be placed in the work zone.

LEGEND

Widening Area



CTP Widening Quick Facts



Construction begins:
September 2025



Ramp closures:
Be mindful of any long-term ramp closures.



Be alert:
Watch for roadway workers.



Completion:
Late 2028
(weather permitting)



Current CTP main lanes in Johnson County



Current CTP main lanes in Johnson County

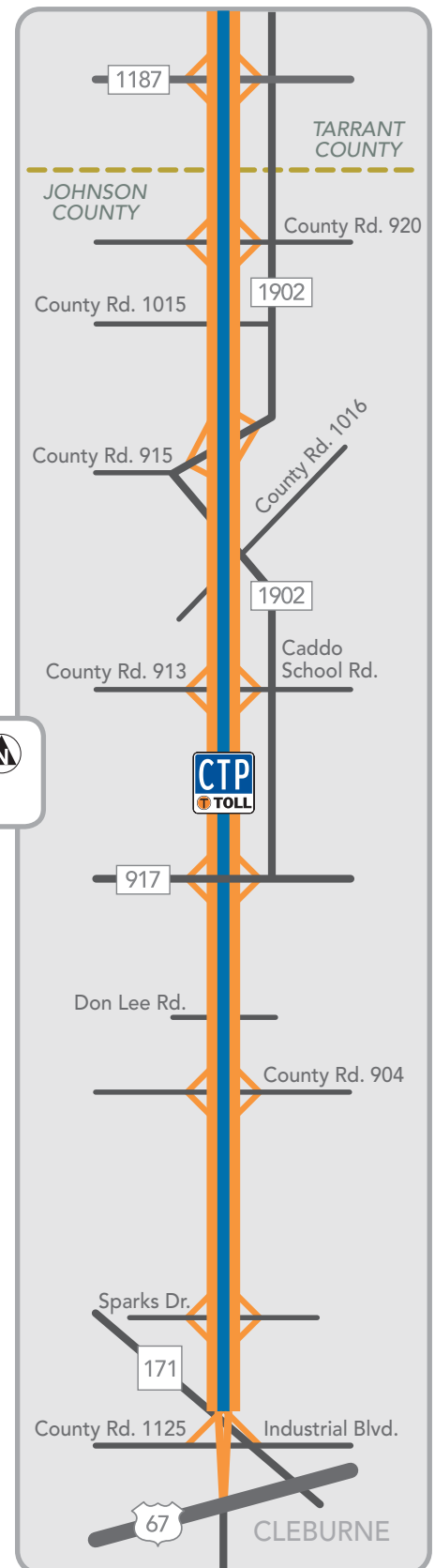

Have any project-related questions? Let's connect:

469-608-6880 or progressNTTA@ntta.org



Steps to build a wider Chisholm Trail Parkway

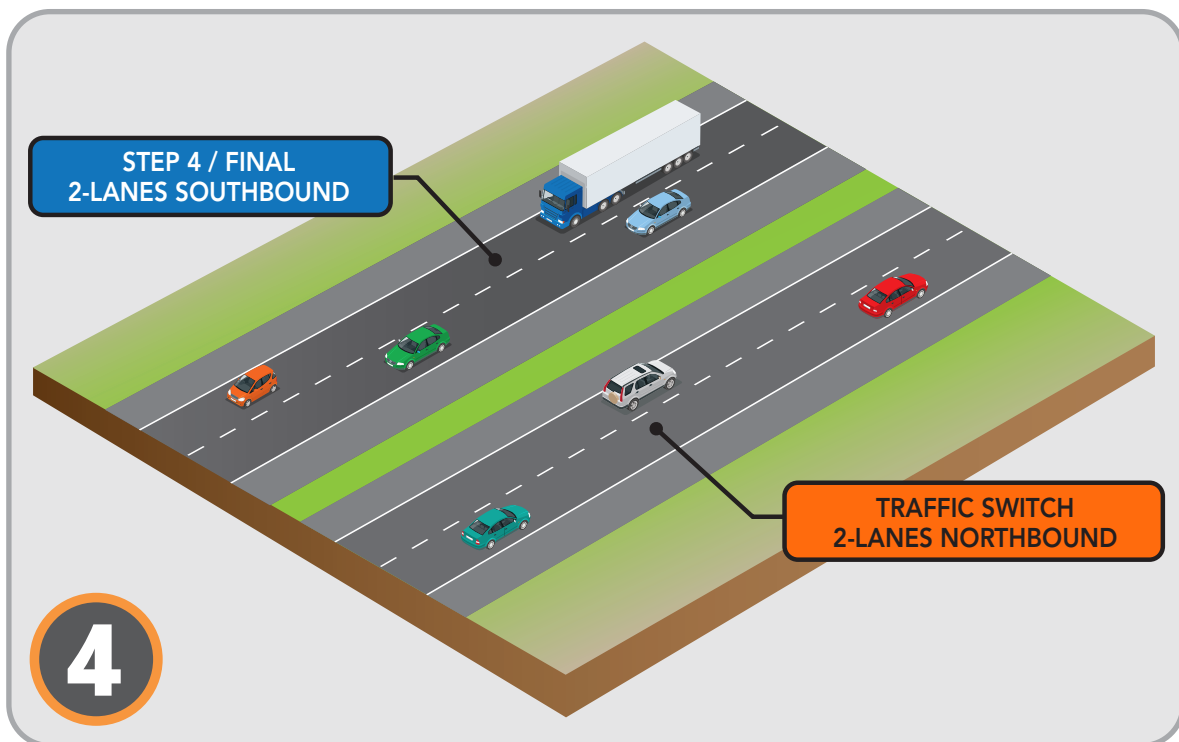
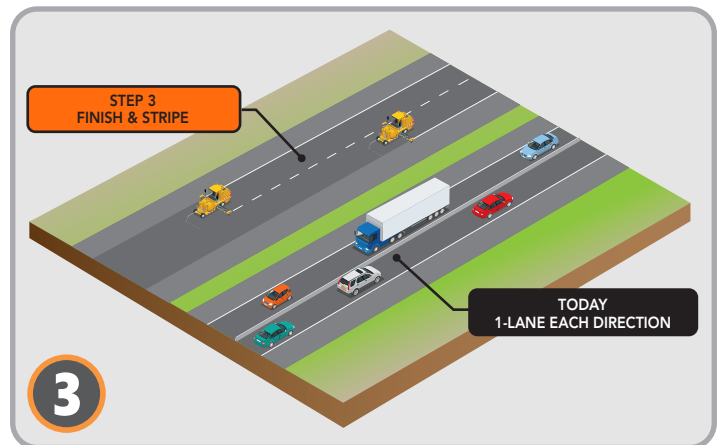
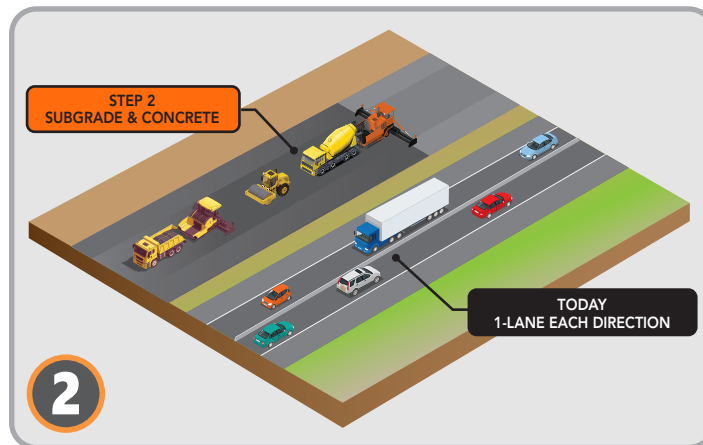
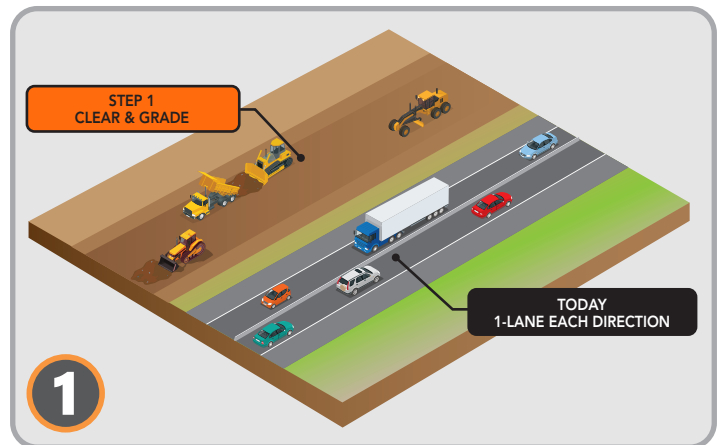
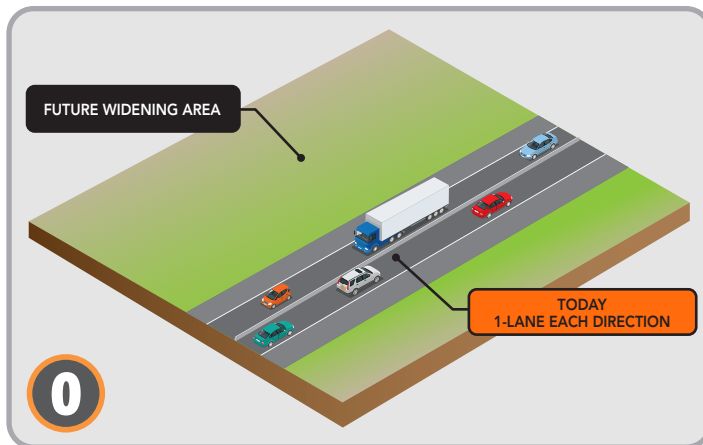

Have any project-related questions? Let's connect:

469-608-6880 or progressNTTA@ntta.org

